

OBJEKT

A.

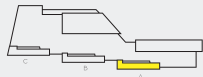

POSCHODIE

3.

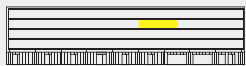

3A.35

PRIESTRANNÝ TROJIZBOVÝ BYT
S KOBKOU PŘAMO NA POSCHODÍ

CELKOVÁ PLOCHA
108,69 m²

PLOCHA BYTU
87,74 m²

PLOCHA LOGGIE
17,87 m²

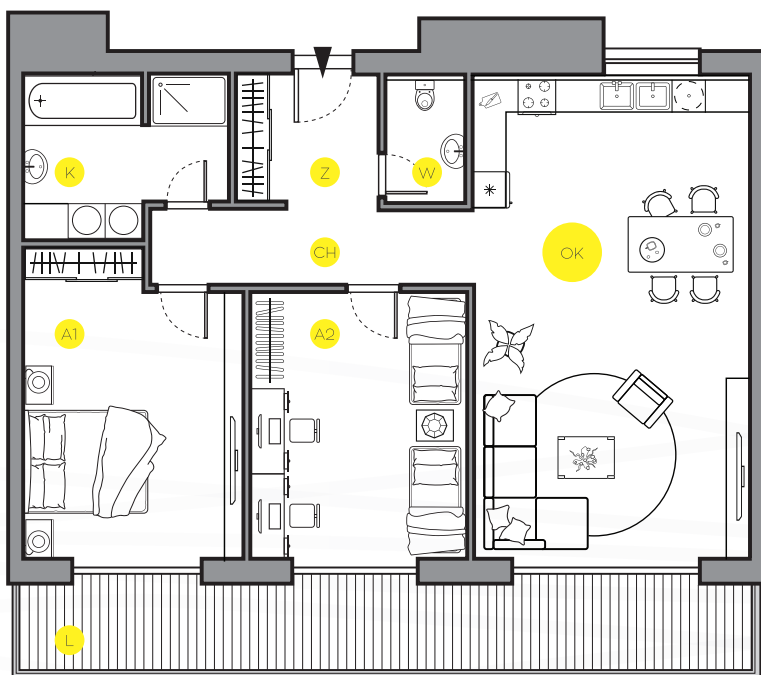

Z	ZÁDVERIE	4,80 m ²
CH	CHODBA	7,33 m ²
OK	OBÝV. + KUCH.	33,97 m ²
A1	IZBA 1	16,60 m ²
A2	IZBA 2	14,71 m ²
W	WC	2,42 m ²
K	KÚPEĽŇA	7,91 m ²
L	LOGGIA	17,87 m ²
↪	KOBKA	3,08 m ²

